



# Installation instructions for your MFD15 Gen2 in the Audi A1/S1

## Beforehand

Thank you for purchasing your CANchecked display for the Audi A1/S1.

During the development of the product, attention was paid to the highest accuracy of fit and quality. The display has been mounted with this installation guide by several test persons and continuously improved, so that you have no problems with the conversion.

If you have feedback, criticism, or change requests for us, please send us an e-mail to [info@canchecked.de](mailto:info@canchecked.de).



## General information

The display is a very sensitive device. One should act with extreme caution here. Any strong pressure on the housing or the display itself should be avoided.

CANchecked assumes no liability for this conversion or for damage during the conversion or during operation. The manual was created to the best of our knowledge and belief.

The conversion time is approx. 30 min. for an experienced screwdriver.

## Required tools

- Step drill (alternatively 10mm drill and file)
- Screwdriver
- 90-degree hook
- Assembly tool (sold separately)

## 1) Dismantle the cladding

Open the driver's door and remove the side dashboard panel. Then you have to clip out the lower fairing on the underside of the driver's footwell. This is not screwed and is completely clipped.



## 2) Expansion of ventilation nozzle

With the help of the 90-degree hook you can now remove the ventilation nozzle. To do this, it is best to insert the hook at the top through the ventilation grille and then push it backwards. At the back there is a small edge where you can hang the hook. Now you can pull the hook and release the ventilation nozzle from the dashboard.



### 3) Dismantling the ventilation nozzle

Circumferential on the back there are small recesses with noses. These must be carefully pressed in so that the frontpanel can be removed.



Now simply pull out the ventilation grille.

**Attention:** the ventilation flap must remain open so that the function continues to exist and the cable can be laid.

### 4) Mounting the display and ventilation adapter

The assembly is now done in reverse order. First, place the OBD2 cable down through a slot in the air duct.

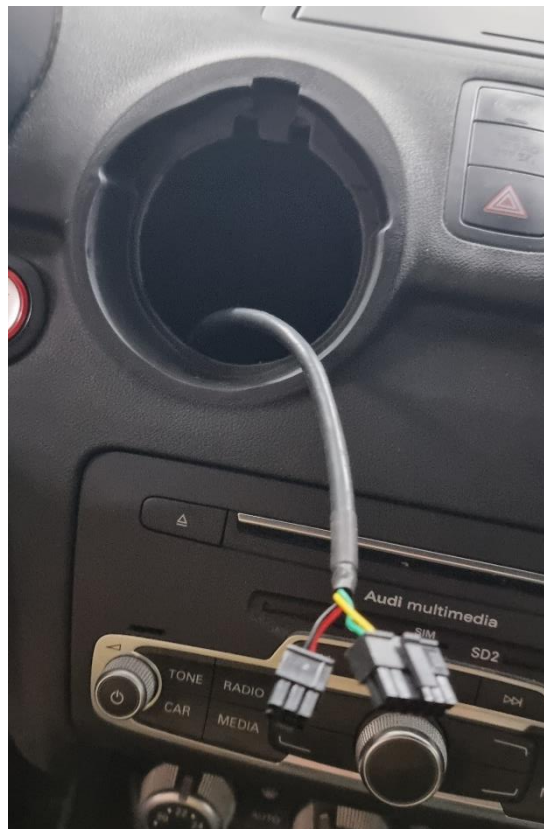



Then insert the display into the adapter and reassemble the ventilation nozzle.  
The adapter has a nose that fits into an opening on the nozzle.

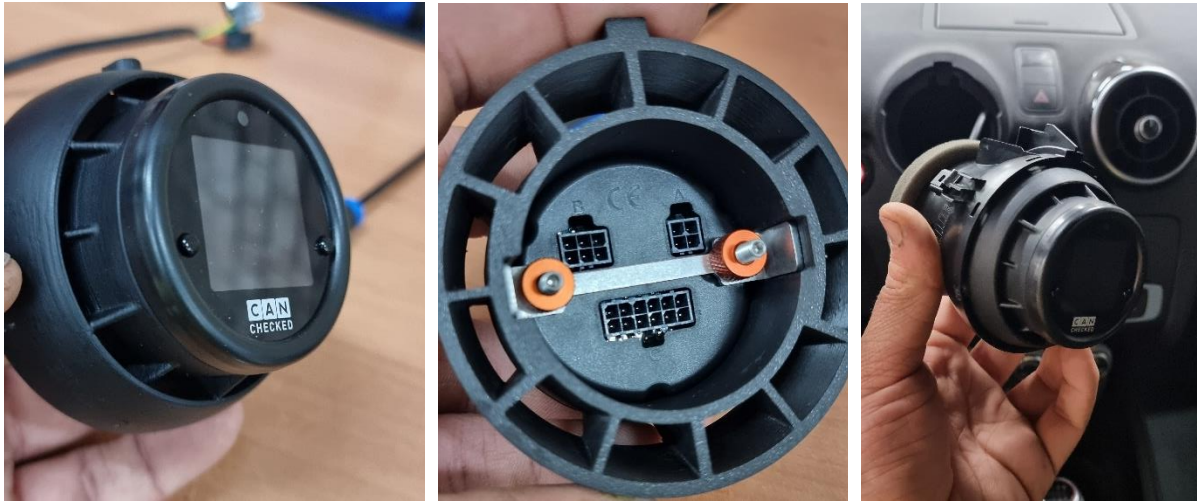

Now plug in the cables and remount the front panel.



## 5) Select TRI and Can Speed

By default, your MFD15 Gen2 starts with active OBD2 TRI. In order to also see the oil temperature and oil pressure in the Audi A1/S1, we have extended the UDS protocol. To activate this, you must press **both buttons** on the front before changing the ignition and hold them while switching on the ignition. Your display now starts in the menu navigation and you now have to select the U-CJX-M.TRI. You can confirm the selection by pressing both buttons synchronously. Then you have to set Can termination and Can Speed. Termination must be set to "**ON**" and speed to 500. The confirmation of the two settings is also done by synchronously pressing the two buttons.

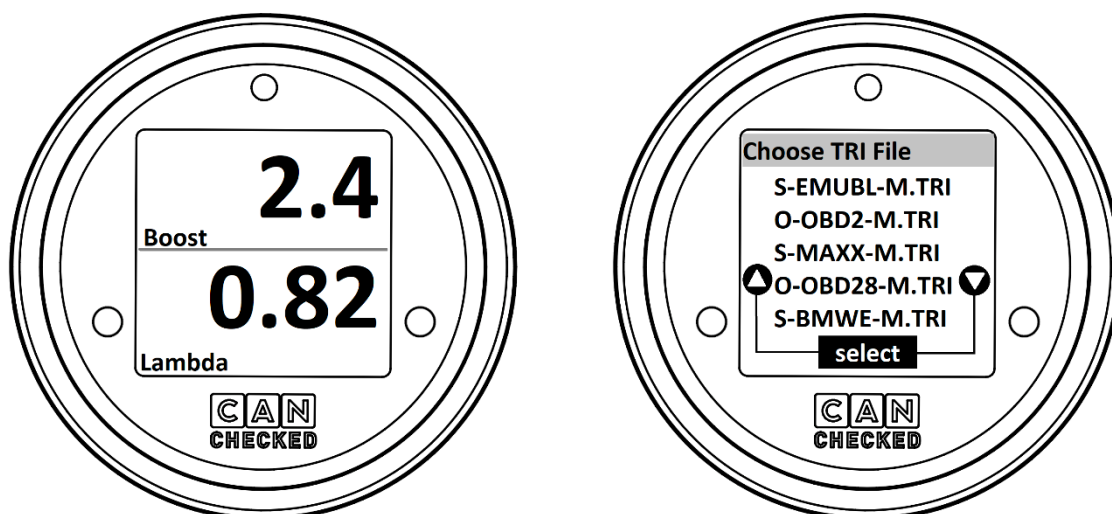

## 6) Accessories and oDSS

You can operate your MFD15 Gen2 not only via the buttons, but also via the rotary potentiometer known from the Gen1. This can be ordered as a separate accessory under the order number CC20001.

Your data display is set up via WLAN via the oDSS. The process for connecting is described in the enclosed Quickstart Guide . If you have any further questions, please have a look at the MFD15 Gen2 manual. You can find this at: <https://www.canchecked.de/downloads/mfd15-mfa2-0-handbuch/>



We hope you have as much fun with your CANchecked display as we do. If you have any questions, please feel free to contact [info@canchecked.de](mailto:info@canchecked.de) by e-mail.

We also have a support group on Facebook where other customers can help and share their experiences:

<https://www.facebook.com/groups/CANcheckedSupport/>